

Installation details.

- ❖ Skimmer box to be mounted horizontally
- ❖ Ensure fascia gasket is secured with stainless steel screws (supplied) and sealant applied around opening to ensure it is water tight.
- ❖ Pack sand or material around skimmer box during pool installation, care must taken when using heavy machinery. Secure pipework with back fill as needed.

Specifications

Model No.	Overall Height	Depth	Weight
EM0030	607mm	482mm	5.96kg / 5.39kg
EM0040	575mm	473mm	4.39kg / 4.04kg

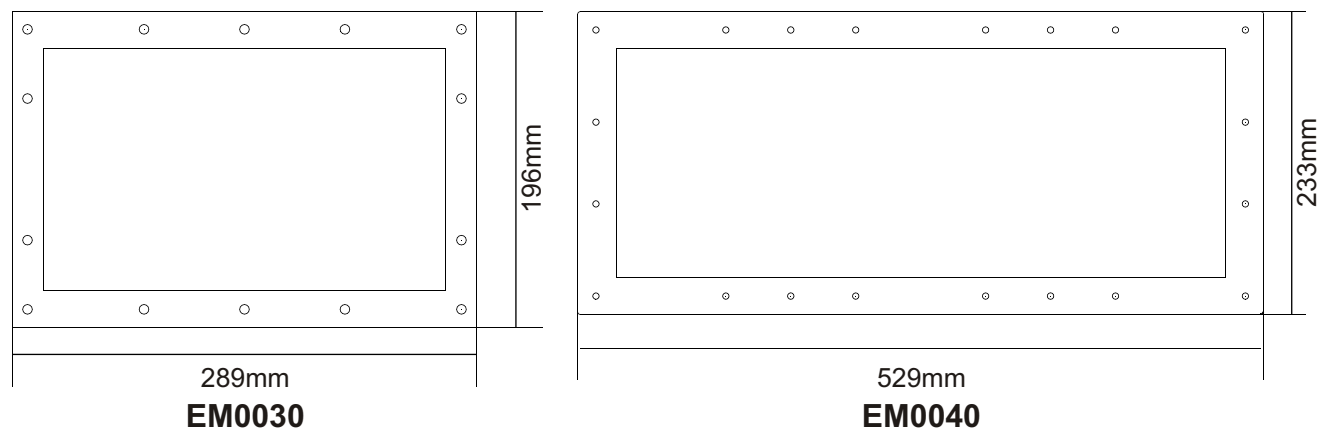

Emaux Standard Wall Skimmer Box. EM0030

- ❖ Made of ABS thermoplastic, UV coated to give excellent strength and durability, the Emaux standard wall skimmer boxes are suitable for all types of domestic swimming pool installations. Each unit has in-built overflow port, and high capacity basket.
- ❖ Outlet port is 50mm with 40mm knockout available.
- ❖ Each Standard Wall Skimmer Box comes with lid, weir door Extension Ring and vacuum plate.
- ❖ Basket & Vacuum plate neatly secured simply by rotating parts into place.

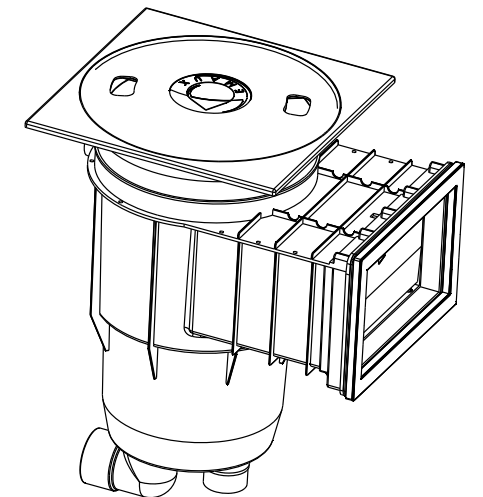

Optional Parts.

- ❖ Round Dress Ring
- ❖ Square Dress Ring

Round Dress Ring

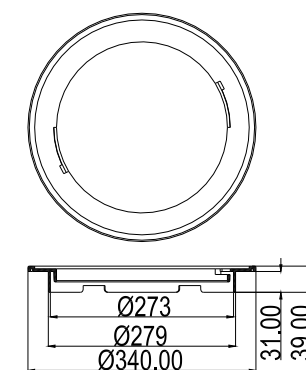

Square Dress Ring

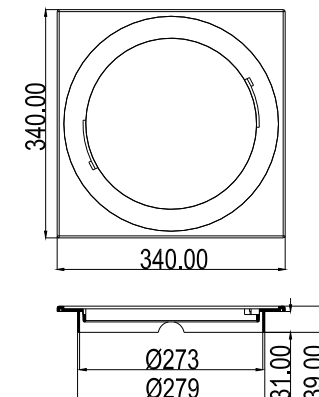

Dimensions

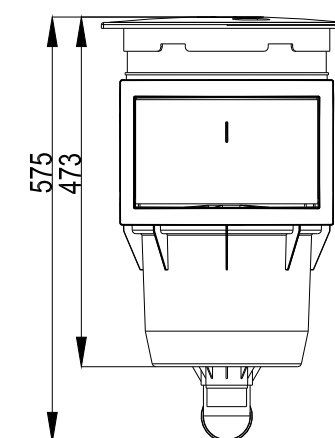
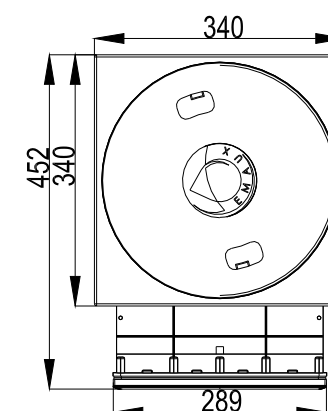

Layout showing available parts for EM0030.

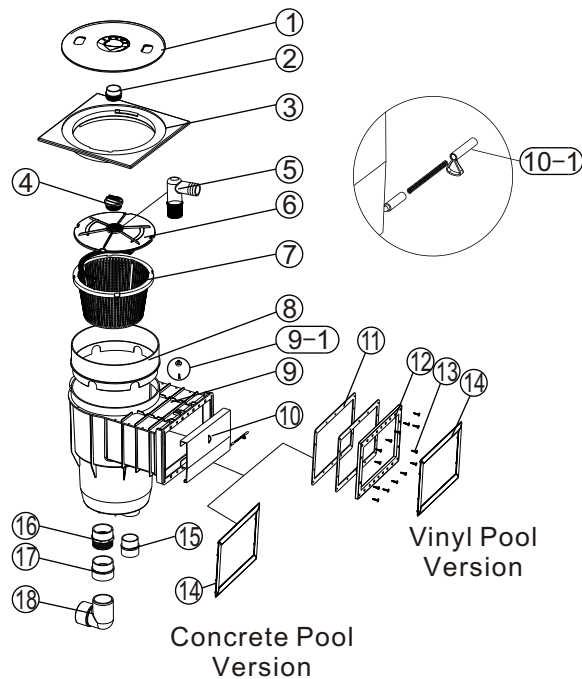

Key NO.	Part Number	Product Description	QTY
1	01211034	Lid	1
2	01050009	Plug for Lid	1
3	01211035	Round Dress Ring	1
	01211036	Square Dress Ring	1
4	01051023	1.5" Plug	1
5	01050007	Vacuum Hose Connector	1
6	01051180	Vacuum Plate	1
7	89150501	Basket With Plastic Handle	1
8	01050004	Height Extension	1
9	89150503	EM0030 & EM0040 Skimmers Body	1
9-1	89150504	Door stopper with screw	1
10	89150502	Weir Door	1
10-1	89150505	Lock & Spring & Pin	1
11	02020021	Gasket for EM0030 Skimmer	2
12	01051184	Frame for EM0030 Skimmer	1
13	03011300	M5.5*35 SS#316 Screws	14
14	01051185	EM0030 Standard Skimmer Face Plate	1
15	01170009	1.5" Union Converter (from Metric to Imperial)	1
16	01170007	2.0" Threaded Union	1
17	01170008	2.0" Union Converter (from Metric to Imperial)	1
18	01170023	2.0" Elbow Union	1

Layout showing available parts for EM0040.

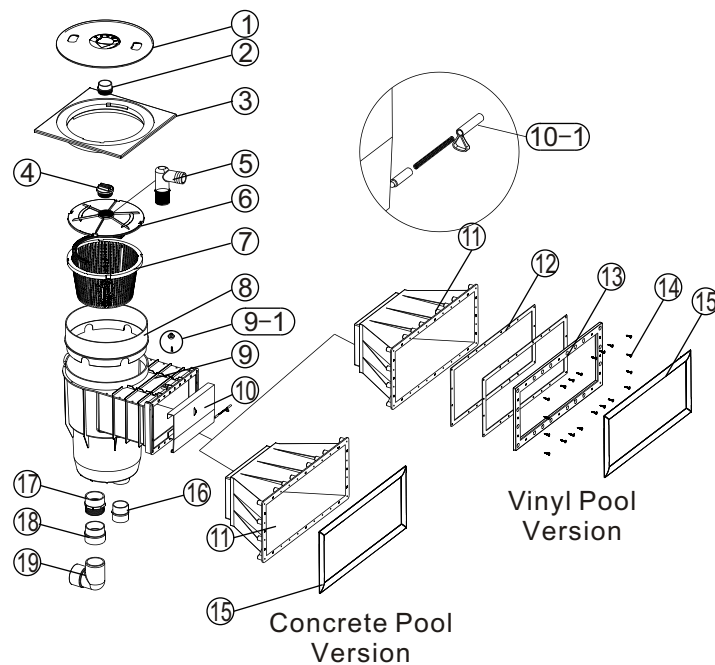

Key NO.	Part Number	Product Description	QTY
1	01211034	Lid	1
2	01050009	Plug for Lid	1
3	01211035	Round Dress Ring	1
	01211036	Square Dress Ring	1
4	01051023	1.5" Plug	1
5	01050007	Vacuum Hose Connector	1
6	01051180	Vacuum Plate	1
7	89150501	Basket With Plastic Handle	1
8	01050004	Height Extension	1
9	89150503	EM0030 & EM0040 Skimmers Body	1
9-1	89150504	Door stopper with screw	1
10	89150502	Weir Door	1
10-1	89150505	Lock & Spring & Pin	1
11	01051183	EM0040 Wide Mouth Extension	1
12	02020022	Gasket for EM0040 Skimmer	2
13	01051187	Frame for EM0040 Skimmer	1
14	03011300	M5.5*35 AISI 316 Screws	16
15	01051188	EM0040 Skimmer Face Plate	1
16	01170009	1.5" Union Converter (from Metric to Imperial)	1
17	01170007	2.0" Threaded Union	1
18	01170008	2.0" Union Converter (from Metric to Imperial)	1
19	01170023	2.0" Elbow Union	1

Emaux Wide Mouth Wall Skimmer Box. EM0040

- ❖ Made of ABS thermoplastic, UV coated to give excellent strength and durability, the Emaux Wide Mouth wall skimmer boxes are suitable for all types of domestic swimming pool installations. Each unit has in-build overflow port, and high capacity basket.
- ❖ Outlet port is 50mm with 40mm knockout available.
- ❖ Each Wide Mouth Wall Skimmer Box comes with lid, weir door Extension Ring and vacuum plate.
- ❖ Basket & Vacuum plate neatly secured simply by rotating parts into place.

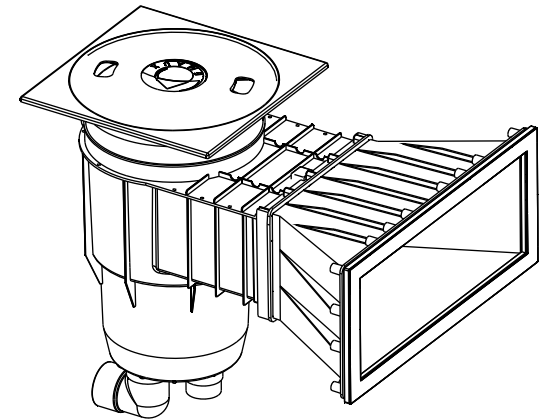

Optional Parts.

- ❖ Round Dress Ring
- ❖ Square Dress Ring

Round Dress Ring

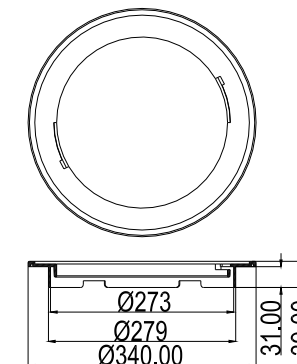

Square Dress Ring

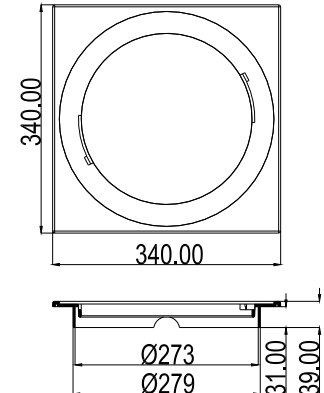

Dimensions

