

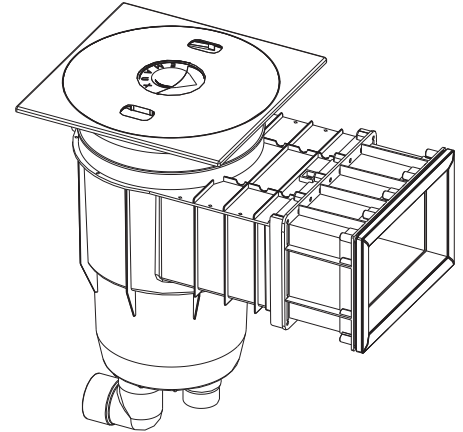

Emaux Standard Wall Skimmer Box. EM0050

- ❖ Made of ABS thermoplastic, UV coated to give excellent strength and durability, the Emaux standard wall skimmer boxes are suitable for all types of domestic swimming pool installations. Each unit has in-built overflow port, and high capacity basket.
- ❖ Outlet port is 50mm with 40mm knockout available.
- ❖ Each Standard Wall Skimmer Box comes with lid, weir door Extension Ring and vacuum plate.
- ❖ Basket & Vacuum plate neatly secured simply by rotating parts into place.
- ❖ Option of round or square dress ring to complement the installation.



Optional Parts.

- ❖ Round Dress Ring
- ❖ Square Dress Ring

Round Dress Ring

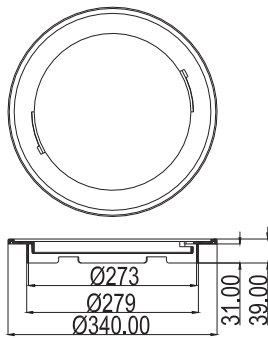

Square Dress Ring

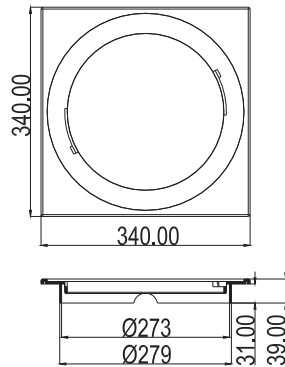

Dimensions

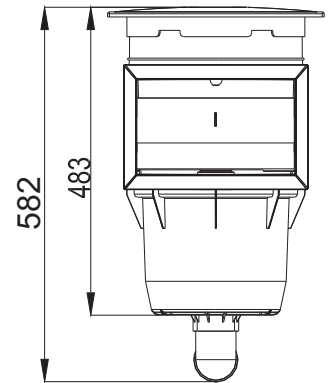
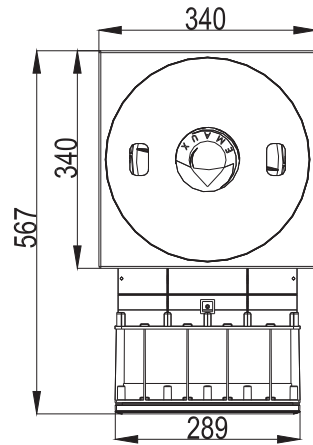

Installation in a tiled pool

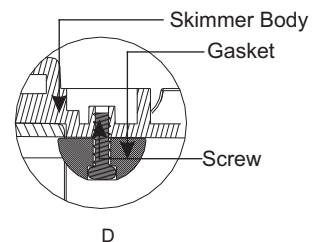
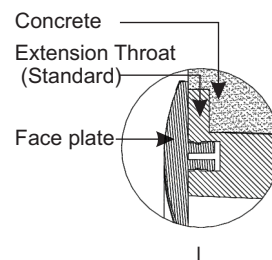
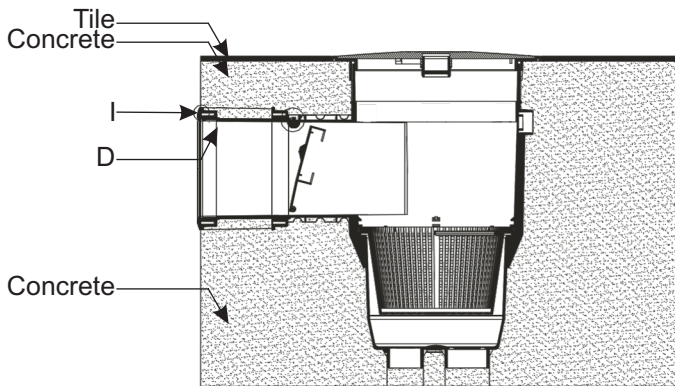

Installation in a vinyl pool

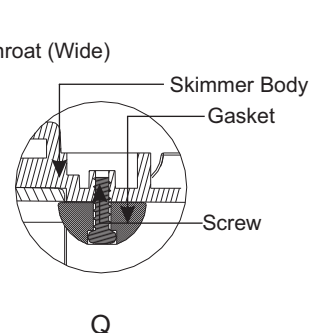
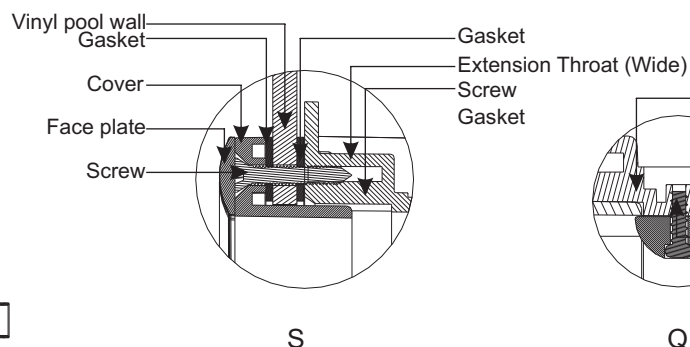
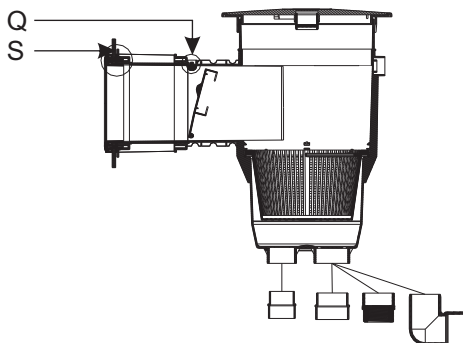



Layout showing available parts for EM0050.

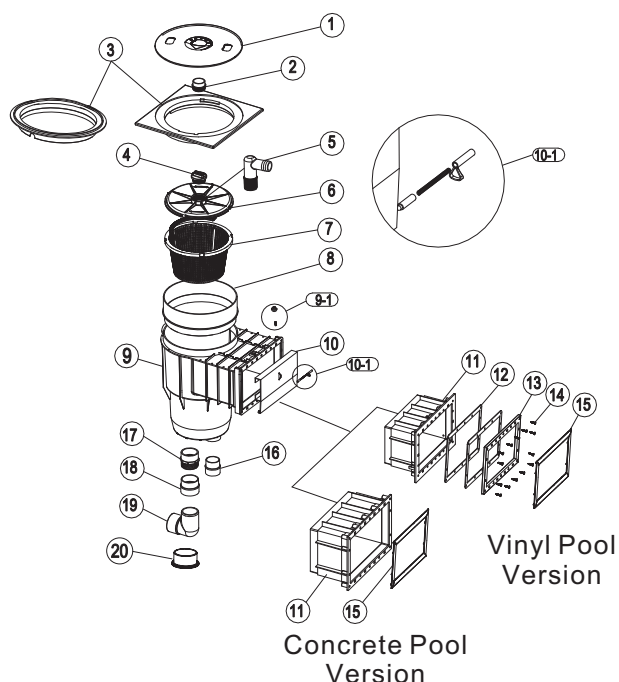

Key NO.	Part NO.	Product Description	QTY
1	01211034	Lid	1
2	01050009	Plug for Lid	1
3	01211035	Round Dress Ring	1
	01211036	Square Dress Ring	1
4	01051023	1.5" Plug	1
5	01050007	Vacuum Hose Connector	1
6	01051180	Vacuum Plate	1
7	89150501	Basket With Plastic Handle	1
8	01050004	Height Extension	1
9	89150503	EM0030 & EM0040 & EM0050 Skimmers Body	1
9-1	89150504	Door stopper with screw	1
10	89150502	Weir Door	1
10-1	89150505	Lock & Spring & Pin	1
11	01050023	Extension Throat (Wide)	1
	01050032	Extension Throat (Standard)	1
12	02020021	Gasket for EM0030 EM0050 Skimmer	1
13	01051184	Frame for EM0030 EM0050 Skimmer	1
14	03011300	M5.5*35 SS#316 Screws	1
15	01051185	EM0030 Standard Skimmer Face Plate	1
16	01170009	1.5" Union Convertor (from Metric to Imperial)	1
17	01170007	2.0" Threaded Union	1
18	01170008	2.0" Union Convertor (from Metric to Imperial)	1
19	01170023	2.0" Elbow Union	1
20	01013123	2.0" Plug	1

Installation details.

- ❖ Skimmer box to be mounted horizontally
- ❖ Use the template sheet provided to drill or punch the holes required on pool wall.
- ❖ For the convenience of installation, use the double sided tape to hold the gasket in place on the pool wall surface, make sure the holes are aligned.
- ❖ Ensure fascia gasket is secured with stainless steel screws (supplied) and sealant applied around opening to ensure it is water tight.
- ❖ Pack sand or material around skimmer box during pool installation, care must be taken when using heavy machinery. Secure pipework with back fill as needed.
- ❖ Install as per latest Standard of the local authority.

Specifications

Model No.	Overall Height	Depth	Weight
EM0050	582mm	483mm	5.11kg / 4.69kg

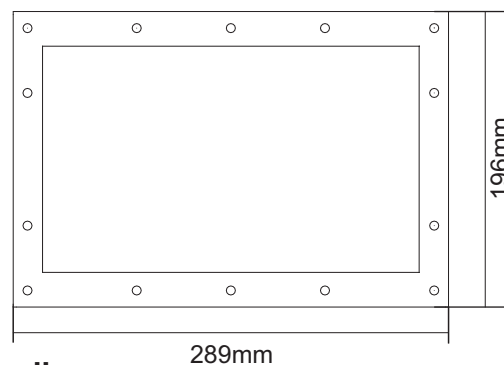

Use the doubled side tape to fix the gasket to the pool wall.

